

AQ-.../AR-... Series consist of enclosures with IP66 degree of protection, containing Ex e and/or Ex i terminals for outside circuit connections. Terminal Boxes AQ-.../AR-... Series are made of Stainless Steel AISI 316L and are especially recommended for chemical agent environments, seawater corrosion, low and high temperature, and other heavy duty environments.

Specifications

Material	Stainless Steel AISI 316L
IP Rating	IP66
Temperature	-50°C to 60°C
Certification & Approvals	EC-Type Examination Certificate INERIS 01ATEX0005X GOST Certificate POCC IT.ГБ04.В00496
Standards	EN 60079-0 / 60079-7 / 60079-11 / 61241-0 / 61241-1 / 61241-11 IEC 60079-0 / 60079-7 / 60079-11 / 61241-0 / 61241-1 / 61241-11
Ex-code	Ex II 2 GD Ex e II T6/T5 Ex ia IIC T6/T5 Ex e ia IIC T6/T5 Ex tD A21 IP66 T85°C/T100°C According to European Directive 94/9/EC (ATEX) For Zone 1/Zone 2 & Zone 21/Zone 22
Lid / Door gasket	POR 303/F/GR/CIG
Surface treatment	Internal and External shot blasting
Material thickness	Body and cover made in AISI 316L thickness 1.5 mm
Quantity for entries	Maximum quantity of entries per side A/B: see table
Standard identification	Identification nameplate is realized in high resistance self-adhesive polyester with thermal transfer inscriptions
Quantity for terminals	Bearing in mind the infinite number of combinations between: quantity of terminals relevant cross section class of temperature ambient temperature ...we suggest using our software CALCUBOX to set up compatible terminals strips. A free copy of CALCUBOX is usually supplied with the Product Catalogue CD and is also available for download from our website.
Earthing	Internal and External earth stud made in AISI 316 suitable for earth wire up to 35 sqmm.
Drain plug	Drain and breather devices type ECR-1, ECR-2, ECR-11
Accessories on request	Identification label stainless steel AISI 304 made, spot welded on cover plate Inside anti-condensation painting Hinged Cover by Stainless Steel AISI 316 made, hinges fixed by spot welding Threaded holes suitable for cable glands, plugs and conduit fitting, either with Metric pitch 1.5, ANSI B1.20.1 NPT, UNI 6125





Maximum number of entries

TYPE	1/2" M20		3/4" M25		1" M32		1 1/4" M40		1 1/2" M50		2" M63		2 1/2" M75		3" M80	
	A	B	A	B	A	B	A	B	A	B	A	B	A	B	A	B
AQ 6	12*	12*	10*	10*	4	4	4	4	3	3	3	3	-	-	-	-
AQ 8	24**	24**	14*	14*	12	12	5	5	4	4	3	3	3	3	2	2
AR 2	10*	6*	8*	4*	3	2	3	2	2	1	2	1	-	-	-	-
AR 4	12*	10*	10*	8*	4	3	4	3	3	2	3	2	-	-	-	-
AR 6	16*	12*	14*	10*	6	4	5	4	4	3	3	3	-	-	-	-
AR 8	36**	24**	20*	14*	18*	12*	7	5	6	4	5	3	4	3	4	2
AR 8A	36**	36**	20*	20*	18*	18*	7	7	6	6	5	5	4	4	4	4

(*) Located on two rows

(**) Located on three rows

Items

TYPE	CODE	A mm	B mm	C mm	D mm	E mm	F mm	Weight Kg.	Internal Mounting Plate	
									mm.	Code
AQ 6	A.4110.06	270	270	130	325	177	350	4,5	222 x 222	P4110.44
AQ 8	A.4110.08	350	350	160	405	257	430	5,6	302 x 302	P4110.45
AR 2	A.4100.02	200	137	130	192	-	217	4,0	152 x 89	P4100.46
AR 4	A.4100.04	270	200	130	255	177	280	7,0	222 x 152	P4100.47
AR 6	A.4100.06	350	270	130	325	257	350	9,5	302 x 222	P4100.48
AR 8	A.4100.08	500	350	160	405	407	430	13,0	452 x 302	P4100.49
AR 8A	A.4100.18	500	500	160	555	407	580	14,5	452 x 452	P4100.50

Dimensions

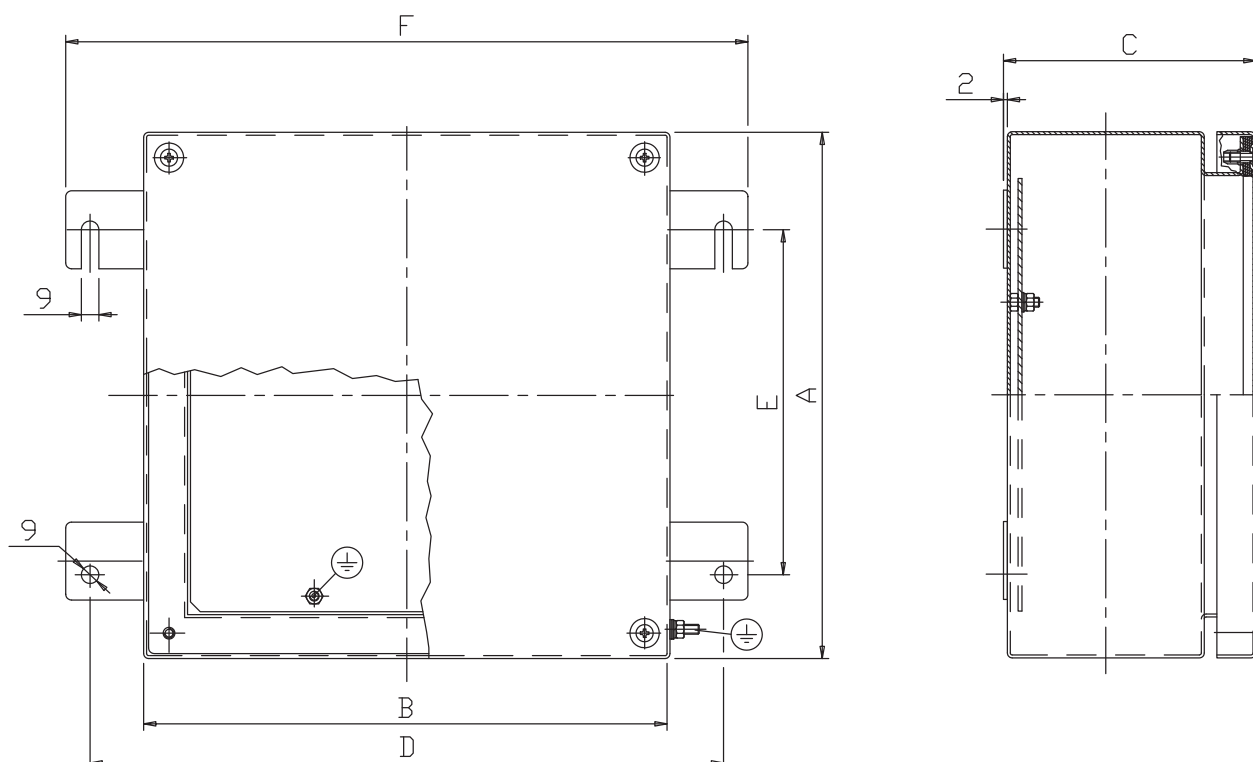

The AQ/AR Enclosure Series with gland plates are made from stainless steel AISI 316L, and are especially recommended for chemical agent environment, sea-water corrosion, low and high temperature, and other heavy duties.

Specifications

Material	Stainless Steel AISI 316L
IP Rating	IP66
Temperature	-50°C to 60°C
Certification & Approvals	EC-Type Examination Certificate INERIS 01ATEX0005X GOST Certificate POCC IT.ГБ04.В00496
Standards	EN 60079-0 / 60079-7 / 60079-11 / 61241-0 / 61241-1 / 61241-11 IEC 60079-0 / 60079-7 / 60079-11 / 61241-0 / 61241-1 / 61241-11
Ex-code	<p>⊕ II 2 GD Ex e II T6/T5 Ex ia IIC T6/T5 Ex e ia IIC T6/T5 Ex tD A21 IP66 T85°C/T100°C According to European Directive 94/9/EC (ATEX) For Zone 1 / Zone 2 / Zone 21 / Zone 22</p>
Lid / Door gasket	POR 303/F/GR/CIG
Surface treatment	Internal and External shot blasting
Material thickness	Body and cover made in AISI 316L thickness 1.5 mm
Quantity for entries	Maximum quantity of entries per side A/B: see table
Standard identification	Identification nameplate is realized in high resistance self-adhesive polyester with thermal transfer inscriptions
Entries thread	As per customer request
Quantity for terminals	<p>Bearing in mind the infinite number of combinations between:</p> <ul style="list-style-type: none"> • quantity of terminals • relevant cross section • class of temperature • ambient temperature <p>...we suggest using our software CALCUBOX to set up the compatible terminals strips. A free copy of CALCUBOX is usually supplied with the CD Catalog and is also available to download from our website.</p>
Earthing	Internal and External earth stud made in AISI 316 suitable for earth wire up to 35 sqmm.
Drain plug	Drain and breather devices type ECR-1, ECR-2, ECR-11
Accessories on request	<p>Drain and breather valve, made from stainless steel AISI 316, with nut/locknut and gasket Mounting plate made in AISI 316L thickness 1.5 mm. Identification label resin/trafolite made, with fixing screws crossing cover plate, sealed by compound to restore IP rating Identification label made from stainless steel AISI 304, spot welded on cover plate Inside anti-condensation painting Hinged cover made from stainless steel AISI 316, hinges fixed by spot welding Threaded holes suitable for cable glands, plugs and conduit fitting, either with Metric pitch 1.5, ANSI B1.20.1 NPT, UNI 6125</p>





Maximum number of entries

TYPE	1/2" M20		3/4" M25		1" M32		1 1/4" M40		1 1/2" M50		2" M63		2 1/2" M75		3" M80	
	A	B	A	B	A	B	A	B	A	B	A	B	A	B	A	B
AQ 6 / FR	5	5	5	5	4	4	3	3	-	-	-	-	-	-	-	-
AQ 8 /FR	14*	14*	6	6	5	5	4	4	4	4	3	3	-	-	-	-
AR 4 /FR	5	4	5	3	4	2	3	2	-	-	-	-	-	-	-	-
AR 6 /FR	7	5	6	5	5	4	4	3	-	-	-	-	-	-	-	-
AR 8 /FR	22*	14*	10	6	8	5	7	4	6	4	5	3	-	-	-	-
AR 8A/FR	22*	22*	10	10	8	8	7	7	6	6	5	5	-	-	-	-

(*) Located on two rows

"FR" is the abbreviation for removable plates, "FR" is not shown in the type number certificate

ITEMS

TYPE	Code	A mm.	B mm.	C mm.	D mm.	E mm.	F mm.	I mm.	L mm.		Mounting Plate		Weight Kg
									1-3	2-4	mm.	Code	
AQ 6/FR	A.4010.06	286	286	130	325	177	350	59	228	228	222 x 222	P.4110.44	5.0
AQ 8/FR	A.4010.08	366	366	160	405	257	430	89	308	308	302 x 302	P.4110.45	6.5
AR 4/FR	A.4000.04	286	216	130	255	177	280	59	228	158	222 x 152	P.4100.47	7.3
AR 6/FR	A.4000.06	366	286	130	325	257	350	59	308	228	302 x 222	P.4100.48	10.0
AR 8/FR	A.4000.08	516	366	160	405	407	430	89	458	308	452 x 302	P.4100.49	13.7
AR 8A/FR	A.4000.18	516	516	160	555	407	580	89	458	458	452 x 452	P.4100.50	15.2

Dimensions

